



**AMERICA'S
EMERGENCY SHELTERS**
100% MADE IN USA for over 20 YEARS

COMMAND

REHAB

SURGE CAPACITY

FIELD HOSPITAL

GROSS DECON

**MASS CASUALTY
DECON**

**CUSTOM TRAILER
AWNING**

PATIENT ISOLATION

EVACUATION

MORGUE



Toll-Free: (800) 932.6003
Phone: (215) 957.6128
www.zumro.com



ZUMRO SHELTERS FEATURES

- **Designed for Emergency use.**
- **Rapid inflation.**
- **Power-assisted deployment.**
- **All Shelters ready in minutes.**
- **FULL INTEROPERABILITY.**
- **Easy to re-position after deployment**
- **Easy set-up in extreme weather.**
- **PRE-ASSEMBLED.**
- **Ready for use immediately.**
- **Versatile for MULTIPLE USES.**
- **Available in 15 sizes**
 - from 50 sq. ft. to 800 sq. ft.
- **Available in 6 colors.**
- **Almost unlimited options & designs.**
- **Built to last for DECADES.**
- **Proven RELIABILITY for OVER 20 YEARS!**
- **THOUSANDS in use throughout the US and Worldwide!**
- **Best warranty in the industry.**
- **Sourced and Manufactured 100% in the USA.**
- **Factory tours welcome.**





DURABLE ALL WEATHER USE

- Drop tested to **100 feet**.
- Deployed and maintained under **750 GPM** water flow.
- Deployed and maintained under **60 Mph** winds.
- Designed for temperatures of -60F to + 140F

SUPERIOR TECHNOLOGY

- **Airtight**, does *NOT* require constant inflation.
- Superior strength at **any temperature**.
- Tapered beam structure for extra strength.
- Mitered, **fully integrated** beam joints.
- Short span between Arch-Sections.
- **Multiple** lateral roof support beams.
- Full base structure support.
- ZUMRO's Neoprene Airframe offers unsurpassed reliability even after extended storage.
- **LOW** air-pressure requirements.
- Most **compact** storage and weight of any Shelter on the market today.



*PROVEN AMERICAN
TECHNOLOGY
FOR THE
HIGH DEMANDS
OF EMERGENCY
RESPONSE*

EFFORTLESS DEPLOYMENT



COMMAND & REHAB

ZUMRO Air Shelters are rapidly-deployed, easy to set-up and are extremely versatile for use as Mobile Command Centers and Rehab.

With a ZUMRO Shelter, the configurations and options are virtually endless. Easy to inflate in minutes with limited personnel, you may set up your ZUMRO Shelter as a Command Center, Communication Hub, Area for Law Enforcement, Personnel Work Center, Sleeping Quarters, Rehab, Restroom, Storage Area, etc.

Available in all sizes from 100 sq. ft. on up.



DECONTAMINATION

PRE-PLUMBED & PRE-ASSEMBLED

Available in Single, 1, 2, 3 and 4- lane configurations



FEATURES

- Pre-assembled canopy, floor, curtains and shower stalls.
- Pre-plumbed showers.
- Removable stalls and curtains for increased versatility
- Full interoperability with all other ZUMRO Shelter Systems & Field Hospitals.
- Multiple decon uses: gross, mass, technical, patient, non-ambulatory personnel, equipment, animal, etc.
- Full line of Decon Accessories available.

FIELD HOSPITAL & SURGE

Featuring MODEL 860 AND QUAD INTERCONNECT SHELTERS



Provide medical personnel with versatile, rapidly-deployed, all-weather, climate-controlled shelters.

ZUMRO's superior design allows for quick set-up and take-down with minimal personnel. Shelters can be staked and deployed in its own footprint and can easily be moved if necessary after inflation.



Versatile Field Hospital Designs & Configurations to meet your specifications.

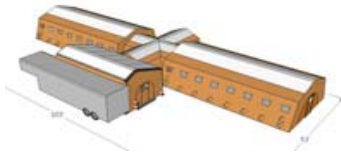
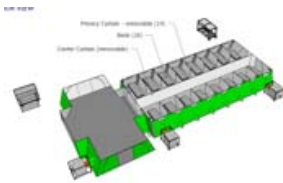

INFLATABLE TRAILER AWNINGS



Key Features:

- Rapid-Deployable
- Fully Enclosed
- Climate Controlled
- Operational in JUST 5 MINUTES!
- Triples Usable Trailer Workspace
- Available in 8 colors!
- Interoperable with ZUMRO Shelters
- CUSTOM SIZES AVAILABLE

ZUMRO's Inflatable Awning Systems are an innovative way to quickly expand your workspace.

Awnings attach with a custom hardware kit to one or both sides of the trailer.

Awning has three doors and utility ducts. Optional HVAC Ducting, Insulation and windows also available.



AVAILABLE FOR ANY SIZE TRAILER including 36' gooseneck style trailers and full 53' foot tractor trailers.

Shelter Model 400

Part # 8200

FEATURES:

- Designed for Emergency Use
- Rapid Inflation
- Full Interoperability
- Easy to re-position after deployment
- Easy to set-up in any weather condition
- PRE-ASSEMBLED
- Customize to your specifications

Versatile uses for a ZUMRO Model 400 include Rehab, Triage, Command, Decon, Isolation/Infection Control, Surge Capacity, Sleeping Quarters, Morgue, Community Events, Additional Workspace, etc.

AVAILABLE OPTIONS & ACCESSORIES

- Integrated LED Light Systems
- Connector Doors and Rigid Doors
- Windows, Identification Panels
- Full line of Decon Shower Accessories
- Non-Ambulatory Patient Tables
- Storage Carts
- HVAC and Electrical Distribution
- Water Heaters



AIR SHELTER MODEL 400, PART # 8200

includes the following:

- Choice of color
- Removable Ground Floor
- Qty 8 Single Utility Ducts
- Center-Zipper Door, front and back
- Ground anchor attachment points
- Shelter deploys in 1-3 minutes
- Standard 110v inflator/deflator
- Carry bag and Maintenance Kit
- Vent Screen (front and back)
- Minimum personnel required to set-up tent - ONE (1)

ZUMRO SHELTERS ARE 100% MADE IN THE USA

STANDARD MODEL 400 SPECIFICATIONS

Length	21'
Width (<i>internal</i>)	19.2'
Width (<i>external</i>)	20'
Height (<i>internal</i>)	10'
Height (<i>external</i>)	10.7'
Floor Area	400 Sq. Ft
Weight	260 Lbs
Stored Size	40"L x 30"W x 24"H
Anchor Points	18
Set-up Time/Blower	5 Minutes
Air volume (<i>approx</i>)	180 Cub.
Ft. Wind Resistance	50 Mph



ZUMRO MDL 600 AIR SHELTER

includes the following:

- Choice of color
- Removable Ground Floor
- Qty 12 Utility Ducts
- Center-Zipper Door, front and back
- Ground anchor attachment points
- Shelter deploys in 2-6 minutes
- Standard 110v inflator/deflator
- Carry bag and Maintenance Kit
- Vent Screen (front and back)

100% MADE IN USA



ZUMRO Part # 8250—MODEL 600 STANDARD TENT SPECIFICATIONS

Length	31'
Width (<i>internal</i>)	19'3"
Width (<i>external</i>)	20'4"
Height (<i>internal</i>)	9'
Height (<i>external</i>)	9'7"
Floor Area	600 Sq.Ft
Weight	450 Lbs
Stored Size	72"L x 33"W x 33"H
Anchor Points	26
Set-up Time / Blower	5-6 Minutes
Set-up Time / Airbottle	180 Seconds
Wind Resistance	50 Mph

ZUMRO MODEL 600 AIR SHELTER FEATURES:

- Designed for Emergency Use
- Rapid Inflation
- Full Interoperability
- Easy to re-position after deployment
- Easy to set-up in any weather condition
- PRE-ASSEMBLED
- Customize to your specifications

Versatile for Multiple Events, ZUMRO Model 600 uses include Rehab, Triage, Command, Isolation/Infection Control, Surge Capacity, Sleeping Quarters, Morgue, Community Events, Additional Field Workspace, etc.

Available accessories include:

- Pre-Installed LED Light Systems
- Connector Doors, Windows, Identification Panels
- Storage Carts
- Heaters, Air Conditioning, and Electrical Distribution



ZUMRO MDL 700 AIR SHELTER

includes the following:

- Choice of color
- Removable Ground Floor
- Qty 12 Utility Ducts
- Center-Zipper Door, front and back
- Ground anchor attachment points
- Shelter deploys in 2-6 minutes
- Standard 110v inflator/deflator
- Carry bag and Maintenance Kit
- Vent Screen (front and back)
- Minimum personnel required to set-up tent

ZUMRO Model 700 Shelter

- Based on proven Model 860 Frame span
- 12 private patient rooms ~ 40 Sq. Ft. each

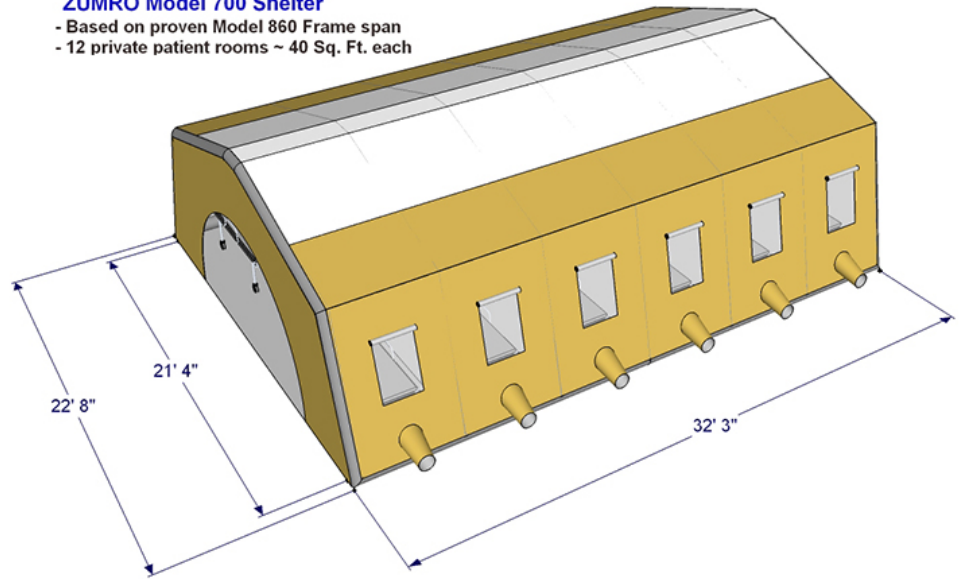

ZUMRO Part # 8400—MODEL 700 STANDARD TENT SPECIFICATIONS

Length	32' 3"
Width (<i>internal</i>)	21' 4"
Width (<i>external</i>)	22' 8"
Height (<i>internal</i>)	10'
Height (<i>external</i>)	10' 7"
Floor Area	700 Sq.Ft
Weight	450 Lbs
Stored Size	75"L x 33"W x 33"H
Anchor Points	28
Set-up Time / Blower	5-6 Minutes
Set-up Time / Airbottle	180 Seconds
Wind Resistance	50 Mph

ZUMRO MODEL 700 AIR SHELTER FEATURES:

- Designed for Emergency Use
- Rapid Inflation
- Full Interoperability
- Easy to re-position after deployment
- Easy to set-up in any weather condition
- PRE-ASSEMBLED
- Customize to your specifications

Versatile for Multiple Events, ZUMRO Model 700 uses include Rehab, Triage, Command, Isolation/Infection Control, Surge Capacity, Sleeping Quarters, Morgue, Community Events, Additional Field Workspace, etc.

Available accessories include:

- Pre-Installed LED Light Systems
- Connector Doors, Windows, Identification Panels
- Storage Carts
- Heaters, Air Conditioning, and Electrical Distribution



ZUMRO SHELTERS MDL 860

includes the following:

- Choice of color
- Removable Ground Floor
- Qty 16 Utility Ducts
- Center-Zipper Door, front and back
- Ground anchor attachment points
- Shelter deploys in 5-7 minutes
- Standard 110v inflator/deflator
- Carry bag and Maintenance Kit
- Vent Screen (front and back)
- Minimum personnel required to set-up tent
- 100% MADE IN USA



End View, shown with Connector Door Part #7837.

Center Divider creates 2 isles, together with 14 privacy curtains create 16 private patient rooms.



Windows with Roll-up Cover Part #7814, shown with Cover rolled open. Up to 16 available.

Shown with standard utility ducts 16 included per tent.

ZUMRO SHELTERS PART # 8300 MODEL 860 TENT SPECIFICATIONS

Length	42'
Width (<i>internal</i>)	20.5'
Width (<i>external</i>)	21.8"
Height (<i>internal</i>)	10'
Height (<i>external</i>)	10.7'
Floor Area	861 Sq.Ft
Weight	530 Lbs
Stored Size	78"L x 34"W x 34"H
Anchor Points	26
Set-up Time / Blower	5-7 Minutes
Wind Resistance	50 Mph

ZUMRO SHELTERS MODEL 860 FEATURES:

- Designed for Emergency Use
- Rapid Inflation
- Full Interoperability
- Easy to re-position after deployment
- Easy to set-up in any weather condition
- PRE-ASSEMBLED
- Customize to your specifications

Versatile for Multiple Events, ZUMRO SHELTERS Model 860 uses include Field Hospital, Command, Rehab, Triage, Surge Capacity, Sleeping Quarters, Morgue, Community Events, Additional Field Workspace, etc.

Available accessories include:

- Pre-Installed LED Light Systems
- Connector Doors, Windows, Identification Panels
- Storage Carts
- Heaters, Air Conditioning, and Electrical Distribution
- Dual SCBA connection hose

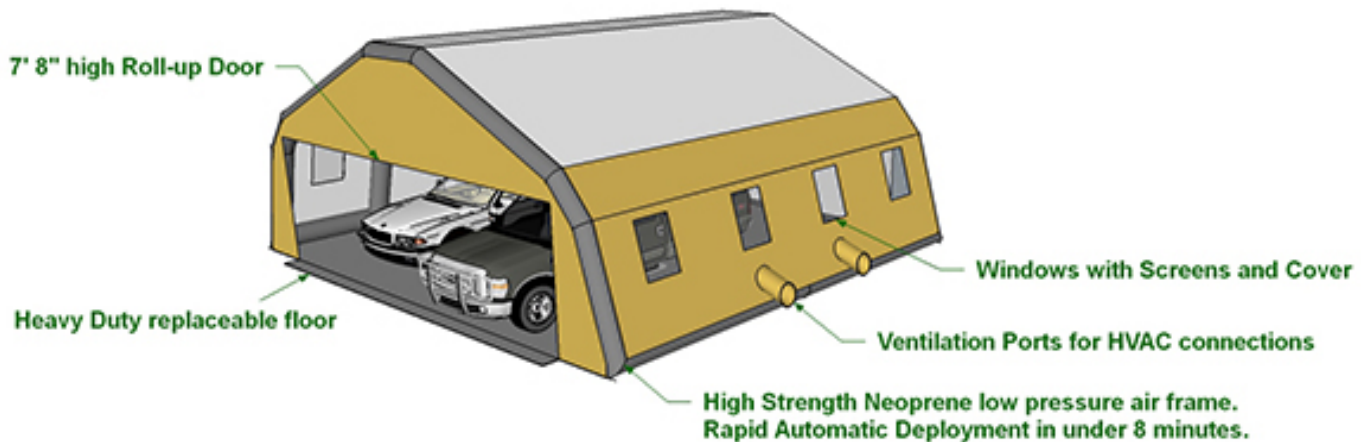

ZUMRO Mdl 900 Immunization Shelter *includes the following:*

- 900 Sq. Ft. Interior Usable Space
- Two Lanes can accommodate 4 vehicles
- Choice of color
- Removable Ground Floor
- Qty 4 Utility Ducts
- Center-Zipper Door, front and back
- Ground anchor attachment points
- Shelter deploys in 5-7 minutes
- Standard 110v inflator/deflator
- Carry bag and Maintenance Kit
- Vent Screen (front and back)

ACCESSORIES SOLD SEPARATELY

- Qty 2 speedbumps, each @ 8ft L
- Carbon Monoxide Alarm
- Dual Fan Ventilation System, 7600 CFM

ZUMRO SHELTERS ARE 100% MADE IN USA

Over 6000 Shelters sold in the US and World-Wide!

ZUMRO Airframes can last over 30 years!

ZUMRO AIR SHELTER FEATURES:

- Designed for Emergency Use
- Rapid Inflation
- Full Interoperability
- Easy to re-position after deployment
- Easy to set-up in any weather condition
- PRE-ASSEMBLED
- Customize to your specifications
- Superior Neoprene Airframe meets military standards
- Airtight, does not require constant inflation!
- Operates at low air-pressure, 3.5 psi
- Easy to set-up, minimal personnel required.
- 3 Year Warranty on all Shelters.

Versatile for Multiple Events, ZUMRO Shelter uses include Field Hospital, Command, Rehab, Triage, Surge Capacity, Sleeping Quarters, Morgue, Community Events, Additional Field Workspace, etc.

Available accessories include:

- Pre-Installed LED Light Systems
- Identification Panels
- Heaters, Air Conditioning, and Electrical Distribution
- Dual SCBA connection hose

ZUMRO Part # 8330—MODEL 900 STANDARD TENT SPECIFICATIONS

Length	30'
Width (<i>internal</i>)	30.1'
Width (<i>external</i>)	32.9"
Height (<i>internal</i>)	10'
Height (<i>external</i>)	13'10"
Floor Area	900 Sq.Ft
Weight	580 Lbs
Stored Size	78"L x 34"W x 34"H
Anchor Points	26
Set-up Time / Blower	5-7 Minutes
Wind Resistance	50 Mph

ZUMRO QUAD INTERFACE HUB SHELTER Part # 8350



ZUMRO SHELTERS MODEL QUAD

includes the following:

- Choice of color
- Removable Ground Floor
- Qty 4 Utility Ducts
- Connector Doors with Roll-up Doors, All Sides
- Ground anchor attachment points
- Shelter deploys in 5 minutes
- Standard 110v inflator/deflator
- Carry bag and Maintenance Kit
- Vent Screen (front and back)
- Minimum personnel required to set-up tent
- Can be used as stand-alone shelter
- 100 % Made in America

ZUMRO SHELTERS Part # 8350— QUAD SPECIFICATIONS

OVERALL SIZE	19' 5" x 29' 4"
Width (<i>internal</i>)	14'9"
Height (<i>internal</i>)	8'
Floor Area	454 Sq.Ft
Weight	390 lbs.
Stored Size	50" x 29" x 24"
Set-up Time / Blower	5-7 Minutes

Available accessories include:

- Pre-Installed LED Light Systems
- Windows, Identification Panels
- Storage Carts
- Heaters, Air Conditioning, and Electrical Distribution



SAMPLE SHELTER COMBINATIONS

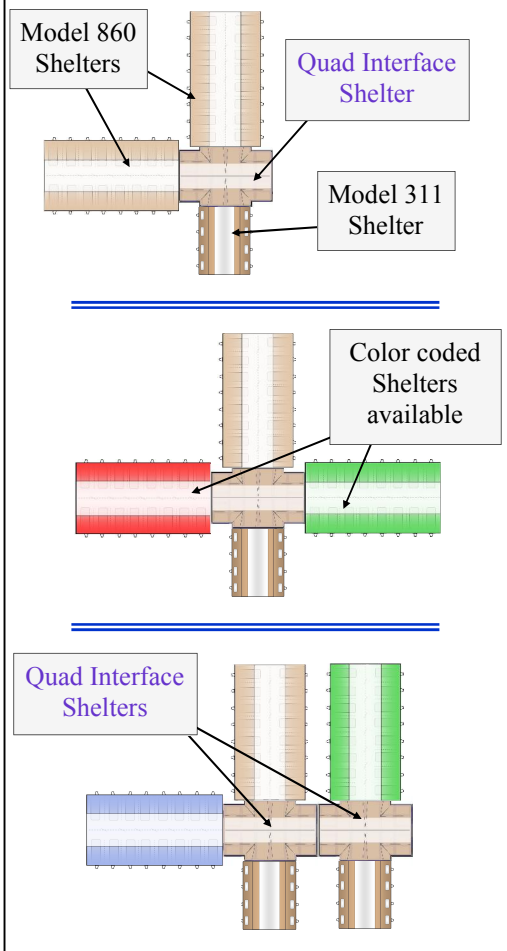

ZUMRO SHELTER QUAD INTERFACE FEATURES:

- Designed for Emergency Use
- Rapid Inflation
- Full Interoperability
- Easy to re-position after deployment
- Easy to set-up in any weather condition
- PRE-ASSEMBLED
- Customize to your specifications

Versatile for Multiple Events, ZUMRO SHELTERS Quad Interface uses include Field Hospital, Command, Rehab, Triage, Surge Capacity, Sleeping Quarters, Morgue, Community Events, Additional Workspace, etc.

ZUMRO UNIVERSAL AWNING 14'-18'

includes the following:

- Choice of color
- Qty 2 Single Utility Ducts
- Custom Awning Connector Door with Roll-up Man-Door (Left/Right)
- Connector Door Transfer Panel with Roll-up Man-Door (Front)
- Custom Trailer Awning Connection Flap (**customer specific dimensions required**)
- Ground anchor attachment points
- Removable Ground Floor
- Standard 110v inflator/deflator
- Carry bag and Maintenance Kit

ZUMRO SHELTERS ARE 100% MADE IN THE USA



ZUMRO UNIVERSAL AWNING FEATURES:

- Designed for Emergency Use
- Rapid Inflation
- Full Interoperability
- Easy to re-position after deployment
- Easy to set-up in any weather condition
- PRE-ASSEMBLED
- Customize to Your Specifications

Versatile for Multiple Events and Situations:

Rehab, Triage, Command, Surge Capacity, Sleeping Quarters, Community Events, Additional Field Workspace, etc.

Full Turn-Key Systems Customized to Your Requirements

Available accessories include:

- Pre-Installed LED Light Systems
- Clear Windows, Screen Windows, Identification Panels
- Storage Carts
- Heaters, Air Conditioning, and Electrical Distribution
- Rigid Door
- Divider Curtains
- Room Dividers for Privacy
- Radiant barrier for insulation
- HVAC ducting to distribute air



Key Features:

- TAILORED to FIT YOUR VEHICLE
- Rapid-Deployable
- Fully Enclosed
- Climate Controlled
- Operational in JUST 5 MINUTES!
- Triples Usable Trailer Workspace
- Extremely Versatile:
 - REHAB
 - COMMAND
 - SURGE CAPACITY
 - FIELD HOSPITAL
- Available in 5 colors!
- Interoperable with other ZUMRO Shelters



CUSTOM AWNING SYSTEMS

43' AWNING SYSTEM

SAN ANTONIO PD

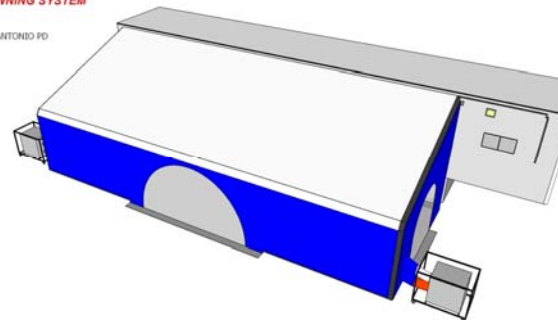

RESCUE TRUCK - CUSTOM AWNING

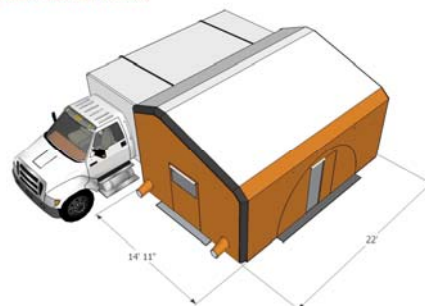

DOUBLE INFLATABLE AWNING SYSTEM

PATRIOT MOBILE MEDICAL SYSTEM

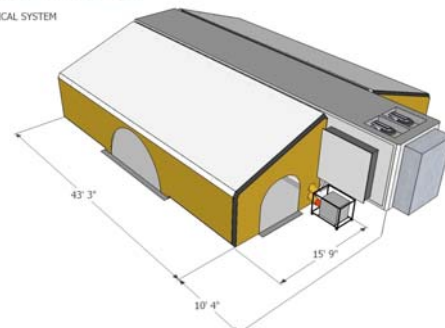

LED Lighting System for ZUMRO Shelters



400 Sq.Ft. Medical Shelter with Pre-Installed LED Lighting provides ~ 13,500 lumens



455 Sq.Ft. ZUMRO Quad Shelter with Pre-Installed LED Lighting provides ~ 21,200 lumens



Control Panel mounted in Aluminum Frame on models with Control Box

Dual Control Switches with indicator light.

25 Foot 12-3 Cord with switched GFI plug.

Dual 110 Volt outlets for auxiliary equipment.

Optional direct 12 Volt wiring harness.

SPECIFICATIONS

LED Light Wave Length.. 4500 K / Natural White
Lumens per Light Strip 2700
Current Draw @12 V 3 Amps per Light Strip or 35 Watts
LED's per Strip 600 to 1200, depending on Shelter Model
LED Voltage 12 Volt DC
Control Box..... 110 Volt with 2 additional 110 Volt outlets.
Transformer..... Fan Cooled 110VAC to 12VDC converter.

ZUMRO's new pre-installed LED (light emitting diode) low voltage lighting is now available on all Shelter models.

The lighting strips remain in the shelter when stored and provide instant lighting upon Shelter deployment.

Four or five (depending on the model) dual element strips run the entire inside length of the shelter and provide a pleasant natural light, not the typical "blue" light associated with common LED's.

The ZUMRO LED lights strips are water-proof and mounted in clear vinyl sleeves for protection. The sleeves are pre-installed onto the Shelter structure.

Each Light Strip is individually pre-wired into the Shelter and can be field replaced by simply unplugging it.

In models with a Control Box, each lighting strip can be individually controlled. The Control Box can be used inside or outside the Shelter. (Basic models: all on/all off only)

Optional colored vinyl "Lenses" are available in Red for Night-Ops.

An optional wiring kit is available for "straight 12 Volt" use, by-passing the 110-to-12VDC Volt Converter Control Box.

All-Aluminum Welded Carts

ZUMRO Aluminum Carts

ZUMRO manufactures a wide variety of all welded Aluminum Carts to store Shelters and related accessories. All Carts manufactured Hatboro, PA. Carts can also be customized by request. (extra charges will apply)

FEATURES:

1. All welded construction.
2. Polished Diamond Plate Shelves.
3. Extra full length shelf standard.
4. Available with Deployment Door.
5. Model 92 available with extra large door for larger Shelters.
6. Model 860 Lift Cart is equipped with shelter lift allowing storage without a carrying case for faster deployment and less handling.



Model 92 Cart with Deployment Door



Basic Cart
#3621/3627
#3621 shown with Mdl 860



LIFT Cart for Model 860 with shelf for Rigid Door

PART #	DESCRIPTION	Fits maximum Shelter Size
3613	CART Model 92 with shelves, welded aluminum	Model 311
3614	CART Model 92-D with shelves and deployment door	Model 311
3615	CART Model 92-XD with shelves and large deployment door	Mdl. 400 / Quad
3616	CART Model 72 with shelves, welded aluminum	Mdl. 400 / Quad
3617	CART Model 72 with shelves and large deployment door	Mdl. 400 / Quad
3618	CART Model 46 with shelves, welded aluminum	none
3619	CART Model 46 with shelves with deployment door	Model 150
3620	LIFT CART for Model 860, welded aluminum	Model 860
3621	BASIC CART for Model 860/ QUAD	Model 860
3627	BASIC CART for Model 150-400	Model 400
3635	ROLL CART for MODEL 216 -311	Model 860
3636	ROLL CART for MODEL 400-440	Model 440

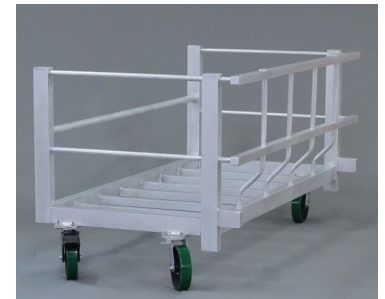

Roll Cart
#3635 / 3636
Cart is designed to fully tilt on side to roll your shelter off the cart!



Part # 9954: 3.5 Ton Portable Trane A/C unit with Heat Pump



- Features:
- Cold/warm air discharge
 - Qty 1-Return air intake
 - Qty 1-Removable intake filter
 - Mounted on a powder coated stackable cart with rolling, locking casters down to 45° F.
 - Removable condensation drain with garden hose connection
 - Rigid return duct with intake grille (24" L x 12" dia)
 - Heat Pump works in temperatures down to 45° F.

Heat Pump not recommended for heat use in temperatures under 45° F

Part # 5418: Portable AC Unit, 14k BTU



- Features:
- 14,000 BTU
 - 2 way air direction circulation
 - Casters to allow for easy movement
 - 115 Volt system
 - Single Vent Hose Configuration
 - Lightweight!

*Please note: **multiple AC units may be required to meet desired cooling temperatures*

PART # 9906 PROPANE FIRED SHELTER HEATER

includes Heater, Blower, Duct and Remote Thermostat

Propane Tent Heater when coupled with the required blower provides fresh warm air for all your confined space needs. This unit is propane fired and electrically powered.
Requires the model 1325D Ventilator to operate. Ships with remote thermostat, and ducting.



PART # 9935 TRI-FUEL SHELTER HEATER

includes Heater, Duct , Remote Thermostat on wheels

Tri-Fuel Tent Heater , indirect heat, provides fresh warm air for all your confined space needs.

This unit utilizes Diesel, Kerosene or Jet Fuels.

A heat exchanger keeps exhaust gas and heated air separate and large capacity fuel tank provides hours of continuous operation.



Includes:

- Flexible Heat Duct and Duct Adaptor
- Remote Thermostat

PART # 9909 STAKE PACKAGE

Qty 4 steel stakes 3/4" x 18"
Qty 4 steel stakes 9"
Qty 6 steel stakes 15"



Multiple packages may be required for larger shelters



ZUMRO ANCHOR BLADDERS

Shelters may be weighed
down with various lengths
of water-filled weight bladders
Easy to set-up
Small storage size

<u>Part No.</u>	<u>Description</u>	<u>Fits Model Shelter</u>
5760	Anchor Bladder Set - 11' (2 @ 60 Gallon each)	108, 150
5761	Anchor Bladder Set - 16' - (2 @ 90 Gallon each)	216
5762	Anchor Bladder Set - 21' - (2 @ 120 Gallon each)	284, 311, 400. (Mdl 860-2 sets reqd.)
5774	Anchor Bladder Set - QUAD Shelter (Set of 4)	Quad
5775	Anchor Bladder Set - Mdl S70 (Set of 2)	S70, Airlock



Manufactured by Air Shelters USA, LLC.
650 SW 16th Terrace, Pompano Beach, FL 33069
U.S.A.

Toll Free: 800/932-6003 International: 215/957-6128

Email: info@zumro.com

Web: www.zumro.com